

PG: #62-14
P. 436
1700364729

MARYLAND HISTORICAL TRUST

INVENTORY FORM FOR STATE HISTORIC SITES SURVEY

1 NAME

HISTORIC

AND/OR COMMON

U.S.D.A.-Beltsville Agricultural Center

2 LOCATION

STREET & NUMBER

U.S. Rte. 1 & Powder Mill Rd.

CITY, TOWN

Beltsville

CONGRESSIONAL DISTRICT

___ VICINITY OF

STATE

Maryland

COUNTY

Prince George's

3 CLASSIFICATION

CATEGORY	OWNERSHIP	STATUS	PRESENT USE
<input type="checkbox"/> DISTRICT	<input checked="" type="checkbox"/> PUBLIC	<input checked="" type="checkbox"/> OCCUPIED	<input checked="" type="checkbox"/> AGRICULTURE
<input type="checkbox"/> BUILDING(S)	<input type="checkbox"/> PRIVATE	<input type="checkbox"/> UNOCCUPIED	<input type="checkbox"/> MUSEUM
<input type="checkbox"/> STRUCTURE	<input type="checkbox"/> BOTH	<input type="checkbox"/> WORK IN PROGRESS	<input type="checkbox"/> COMMERCIAL
<input checked="" type="checkbox"/> SITE	PUBLIC ACQUISITION	ACCESSIBLE	<input type="checkbox"/> PARK
<input type="checkbox"/> OBJECT	<input type="checkbox"/> IN PROCESS	<input type="checkbox"/> YES RESTRICTED	<input type="checkbox"/> EDUCATIONAL
	<input type="checkbox"/> BEING CONSIDERED	<input type="checkbox"/> YES UNRES.	<input checked="" type="checkbox"/> ENTERTAINMENT
		<input type="checkbox"/> NO	<input checked="" type="checkbox"/> GOVERNMENT
			<input type="checkbox"/> RELIGIOUS
			<input checked="" type="checkbox"/> SCIENTIFIC
			<input type="checkbox"/> INDUSTRIAL
			<input type="checkbox"/> PRIVATE RESIDENCE
			<input type="checkbox"/> MILITARY
			<input type="checkbox"/> TRANSPORTATION
			<input type="checkbox"/> OTHER

4 OWNER OF PROPERTY

NAME

United States Dep't. of Agriculture

Telephone #:

STREET & NUMBER

CITY, TOWN

___ VICINITY OF

STATE, zip code

5 LOCATION OF LEGAL DESCRIPTION

COURTHOUSE, REGISTRY OF DEEDS, ETC

Prince George's County Courthouse

Liber #:

Folio #:

STREET & NUMBER

CITY, TOWN

Upper Marlboro

STATE

Maryland

6 REPRESENTATION IN EXISTING SURVEYS

TITLE

DATE

___ FEDERAL ___ STATE ___ COUNTY ___ LOCAL

DEPOSITORY FOR SURVEY RECORDS

CITY, TOWN

STATE

DESCRIPTION

CONDITION		CHECK ONE	CHECK ONE	
<input type="checkbox"/> EXCELLENT	<input type="checkbox"/> DETERIORATED	<input type="checkbox"/> UNALTERED	<input checked="" type="checkbox"/> ORIGINAL SITE	
<input type="checkbox"/> GOOD	<input type="checkbox"/> RUINS	<input type="checkbox"/> ALTERED	<input type="checkbox"/> MOVED	DATE _____
<input type="checkbox"/> FAIR	<input type="checkbox"/> UNEXPOSED			

DESCRIBE THE PRESENT AND ORIGINAL (IF KNOWN) PHYSICAL APPEARANCE

This is a sprawling, 10,400 acre complex of fields, woods, and building complexes. The main administration center, located on Powder Mill Rd., is a series of "Maryland Georgian" style brick buildings, constructed early in this century. There are several older houses and farm complexes, of historic interest, located about the grounds. (See separate forms for each of these historic sites.)

SIGNIFICANCE

PERIOD	AREAS OF SIGNIFICANCE -- CHECK AND JUSTIFY BELOW			
<input type="checkbox"/> PREHISTORIC	<input type="checkbox"/> ARCHEOLOGY-PREHISTORIC	<input type="checkbox"/> COMMUNITY PLANNING	<input type="checkbox"/> LANDSCAPE ARCHITECTURE	<input type="checkbox"/> RELIGION
<input type="checkbox"/> 1400-1499	<input type="checkbox"/> ARCHEOLOGY-HISTORIC	<input type="checkbox"/> CONSERVATION	<input type="checkbox"/> LAW	<input type="checkbox"/> SCIENCE
<input type="checkbox"/> 1500-1599	<input type="checkbox"/> AGRICULTURE	<input type="checkbox"/> ECONOMICS	<input type="checkbox"/> LITERATURE	<input type="checkbox"/> SCULPTURE
<input type="checkbox"/> 1600-1699	<input type="checkbox"/> ARCHITECTURE	<input type="checkbox"/> EDUCATION	<input type="checkbox"/> MILITARY	<input type="checkbox"/> SOCIAL/HUMANITARIAN
<input type="checkbox"/> 1700-1799	<input type="checkbox"/> ART	<input type="checkbox"/> ENGINEERING	<input type="checkbox"/> MUSIC	<input type="checkbox"/> THEATER
<input type="checkbox"/> 1800-1899	<input type="checkbox"/> COMMERCE	<input type="checkbox"/> EXPLORATION/SETTLEMENT	<input type="checkbox"/> PHILOSOPHY	<input type="checkbox"/> TRANSPORTATION
<input checked="" type="checkbox"/> 1900-	<input type="checkbox"/> COMMUNICATIONS	<input type="checkbox"/> INDUSTRY	<input type="checkbox"/> POLITICS/GOVERNMENT	<input type="checkbox"/> OTHER (SPECIFY)
		<input type="checkbox"/> INVENTION		

SPECIFIC DATES

BUILDER/ARCHITECT

STATEMENT OF SIGNIFICANCE

This is the world's major agricultural proving ground and study area. Government acquisition began with the purchase of 475 acres in 1910. During the 1930's and '40's, a series of steps (many prompted by Depression-era programs) resulted in the concentration of the USDA experimental facilities here. It is especially interesting to note that much of the initial interest in the formation of such a facility dates back to the 1850's, with the efforts of two of Mont. & P.G. Counties most famous statesmen/farmers-Francis P. Blair of "Silver Spring" and Charles B. Calvert of "Riversdale".

9 MAJOR BIBLIOGRAPHICAL REFERENCES

- 1) Wisner, Vivian & Rasmussen, Wayne D. "Background for Plenty"
MD. HISTORICAL MAGAZINE, Dec., 1966.

CONTINUE ON SEPARATE SHEET IF NECESSARY

10 GEOGRAPHICAL DATA

ACREAGE OF NOMINATED PROPERTY _____

VERBAL BOUNDARY DESCRIPTION

LIST ALL STATES AND COUNTIES FOR PROPERTIES OVERLAPPING STATE OR COUNTY BOUNDARIES

STATE _____ COUNTY _____

STATE _____ COUNTY _____

11 FORM PREPARED BY

NAME / TITLE

Michael F. Dwyer, Senior Park Historian

ORGANIZATION

M-NCPPC

DATE

1/25/73

STREET & NUMBER

8787 Georgia Ave.

TELEPHONE

589-1480

CITY OR TOWN

Silver Spring

STATE

Maryland

The Maryland Historic Sites Inventory was officially created by an Act of the Maryland Legislature, to be found in the Annotated Code of Maryland, Article 41, Section 181 KA, 1974 Supplement.

The Survey and Inventory are being prepared for information and record purposes only and do not constitute any infringement of individual property rights.

RETURN TO: Maryland Historical Trust
The Shaw House, 21 State Circle
Annapolis, Maryland 21401
(301) 267-1438

UNITED STATES DEPARTMENT OF AGRICULTURE
AGRICULTURAL RESEARCH SERVICE
GENERAL SERVICES DIVISION
HYATTSVILLE, MARYLAND 20782

PG:62-14

APR 2 1975

Mr. Tyler Bastian
Maryland Geological Survey
Latrobe Hall
The Johns Hopkins University
Baltimore, Maryland 21218

Dear Mr. Bastian:

Please refer to your letter of February 20, 1975, to Mr. Zane G. Smith, U.S. Department of Agriculture, Forest Service, and his undated letter of reply, relative to prehistoric Indian sites at the Beltsville Agricultural Research Center.

We, too, are concerned with the preservation of archeological resources on the Research Center and have been alert to the occasional find of arrowheads. We are, however, not aware of any significant findings on sites.

We will appreciate receiving any specific information you may have, relative to abundant prehistoric Indian archeological sites at the Center, so that we may further explore these locations.

Sincerely,

Ralson R. Rhodes
Director

cc:
A. C. Townsend, Dir., Md. Historical Trust, Annapolis ✓

RECEIVED

APR 3 1975
MARYLAND HISTORICAL
TRUST

Property Address U.S. 1 and Powder Mill Road, Beltsville Vicinity, Prince George's County
Owner Name/Address U.S. Department of Agriculture
Year Built circa 1880, circa 1930, circa 1940

Resource Sketch Map and National Register Boundary Map:

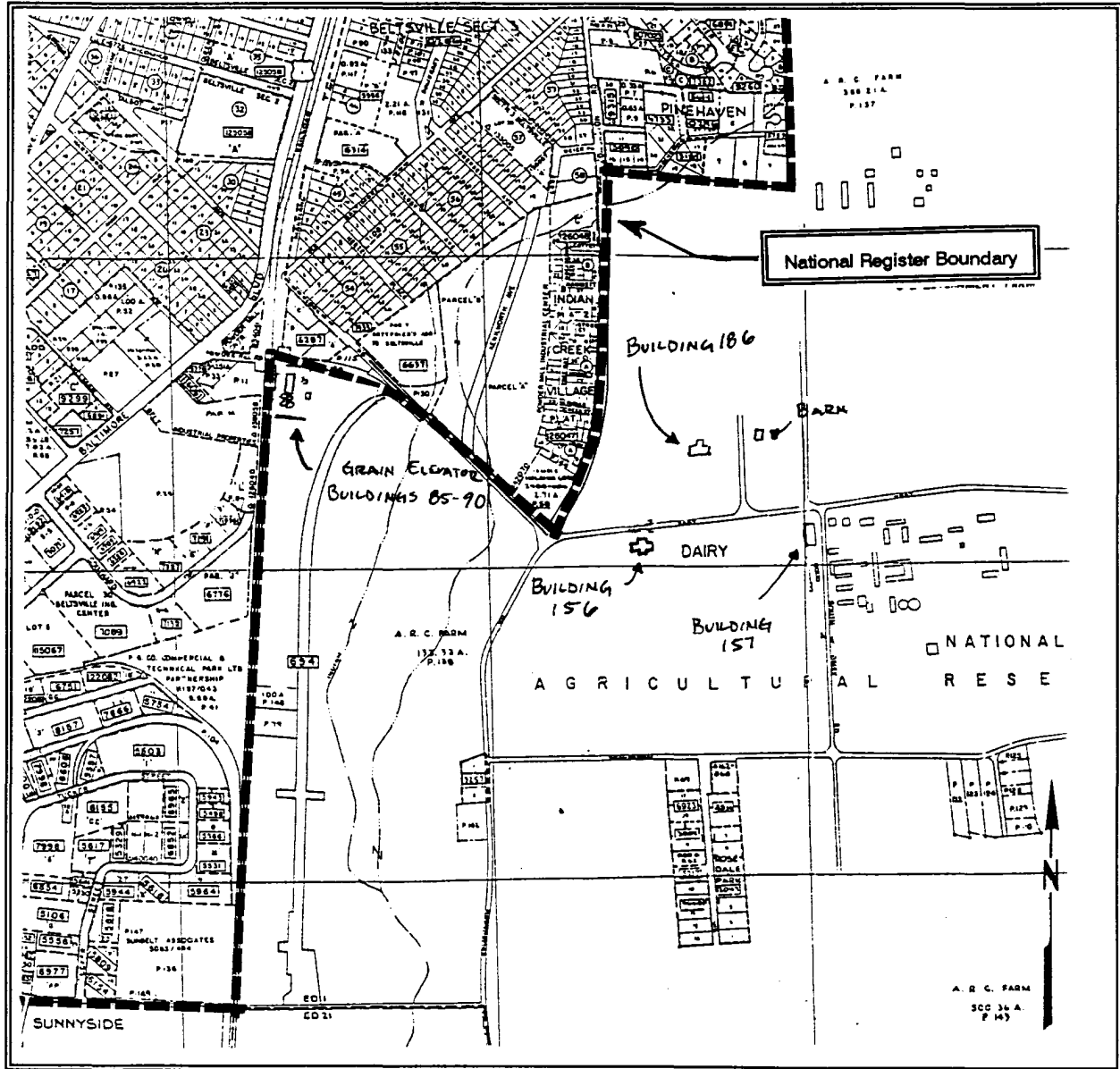

PG: 62-14

Beltsville Agricultural Research Center (BARC)
Beltsville, Prince George's County, Maryland

SEE HISTORIC AMERICAN BUILDINGS SURVEY (HABS) FOR ADDITIONAL INFORMATION.